

# ASSEMBLY LEVEL

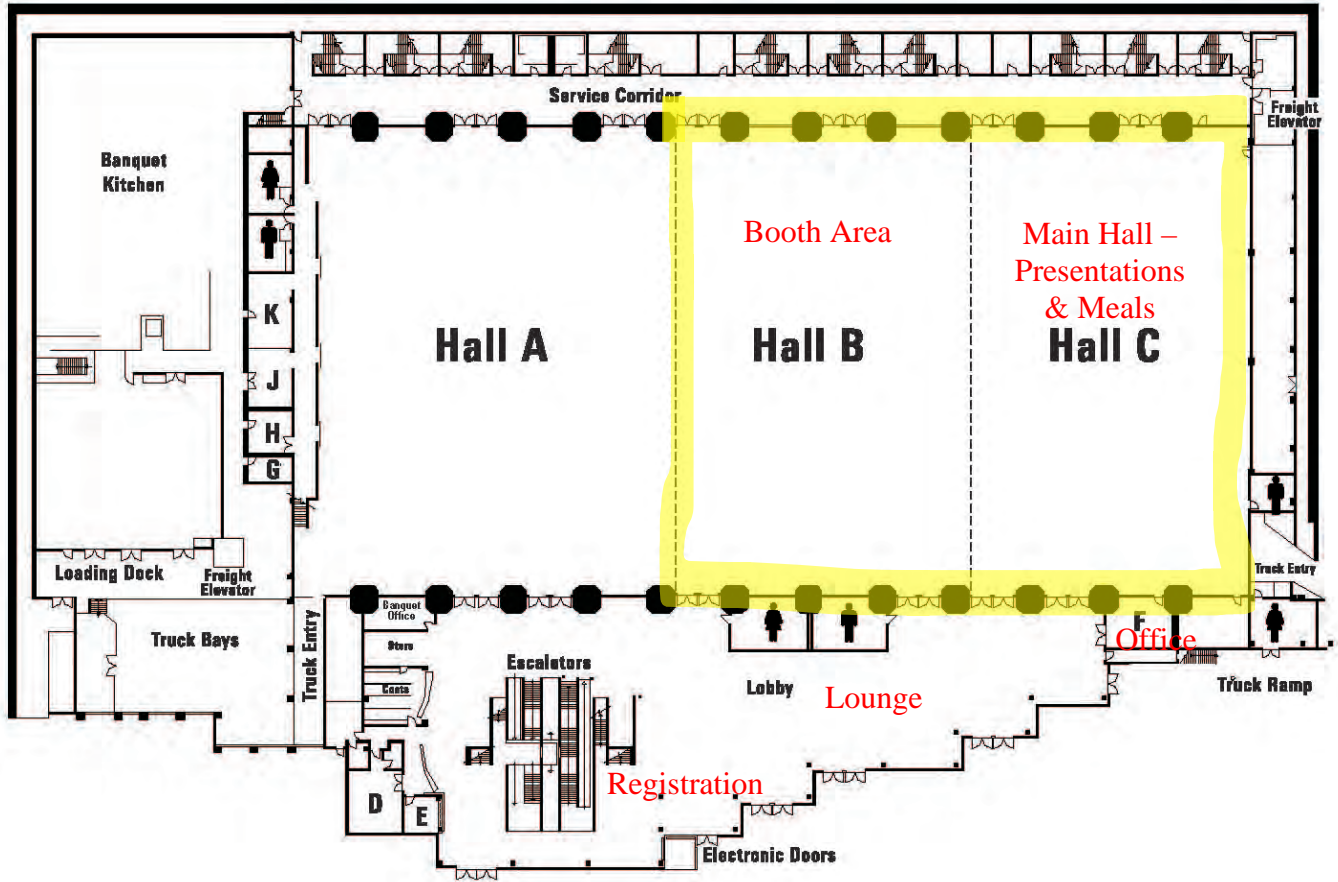

## ASSEMBLY LEVEL

## CAPACITY

## WITH AMENITIES

ROOM	HEIGHT (ft)	DIMENSIONS (ft)	AREA (ft <sup>2</sup> )	AREA (m <sup>2</sup> )	THEATRE	BANQUET		THEATRE	BANQUET
Hall A	29	180 x 154	27,720	2,575.2	2,400	1,800	A	2,250	1,400
Hall B	29	180 x 120	21,600	2,007.4	1,848	1,500	B	1,848	1,120
Hall C	29	180 x 114	20,520	1,907.1	2,100	1,500	C	1,800	1,000
Hall AB	29	180 x 274	49,320	4,587.9	4,200	3,300	AB	4,230	2,660
Hall BC	29	180 x 234	42,120	3,913	3,980	3,200	BC	3,980	2,550
Hall ABC	29	180 x 388	69,840	6,490.7	5,254	4,775	ABC	5,254	4,500
Foyer	19	-	-	-	-	-			

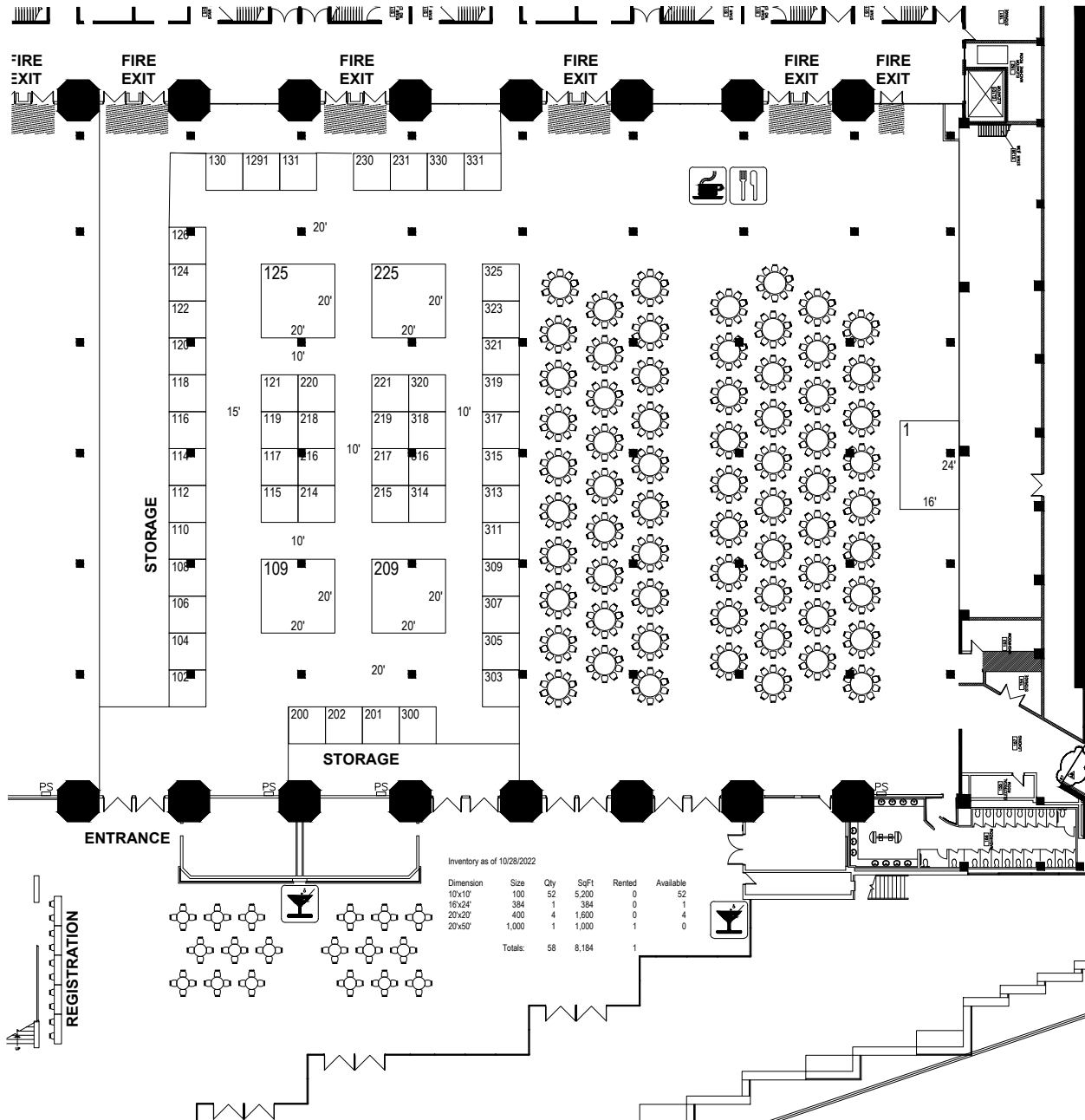

Inventory as of 10/28/2022

Dimension	Size	Qty	SqFt	Rented	Available
10x10	100	52	5,200	0	52
16x24	384	1	384	0	1
20x20	400	4	1,600	0	4
20x50	1,000	1	1,000	1	0
<b>Totals:</b>		<b>58</b>	<b>8,184</b>	<b>1</b>	



COPYRIGHT © 2009 GES CANADA.  
 All Rights Reserved. No part of this publication may be reproduced, stored in any retrieval system, or transmitted in any form or by any means - electronic, mechanical, photocopying, recording, or otherwise - without the express written consent of GES CANADA.  
 Every effort has been made to insure the accuracy of all information contained on this floor plan. However, no warranties, either expressed or implied, are made with respect to this floor plan. If the location of building columns, utilities, or other architectural components of the facility is a consideration in the construction or usage of an exhibit, it is the sole responsibility of the exhibitor to physically inspect the facility to verify all dimensions and locations.

# Canadian Land Reclamation Association

February 22-24, 2023  
 Edmonton Convention Centre  
 Hall B & C

Confidential Property Of GES CANADA  
 File: CLRA\_2023\_3.dwg  
 Layout: GUIDE  
 Plotted: October 28, 2022, 3:02:06 PM  
 By: Tammy Pucchi

# MEETING LEVEL

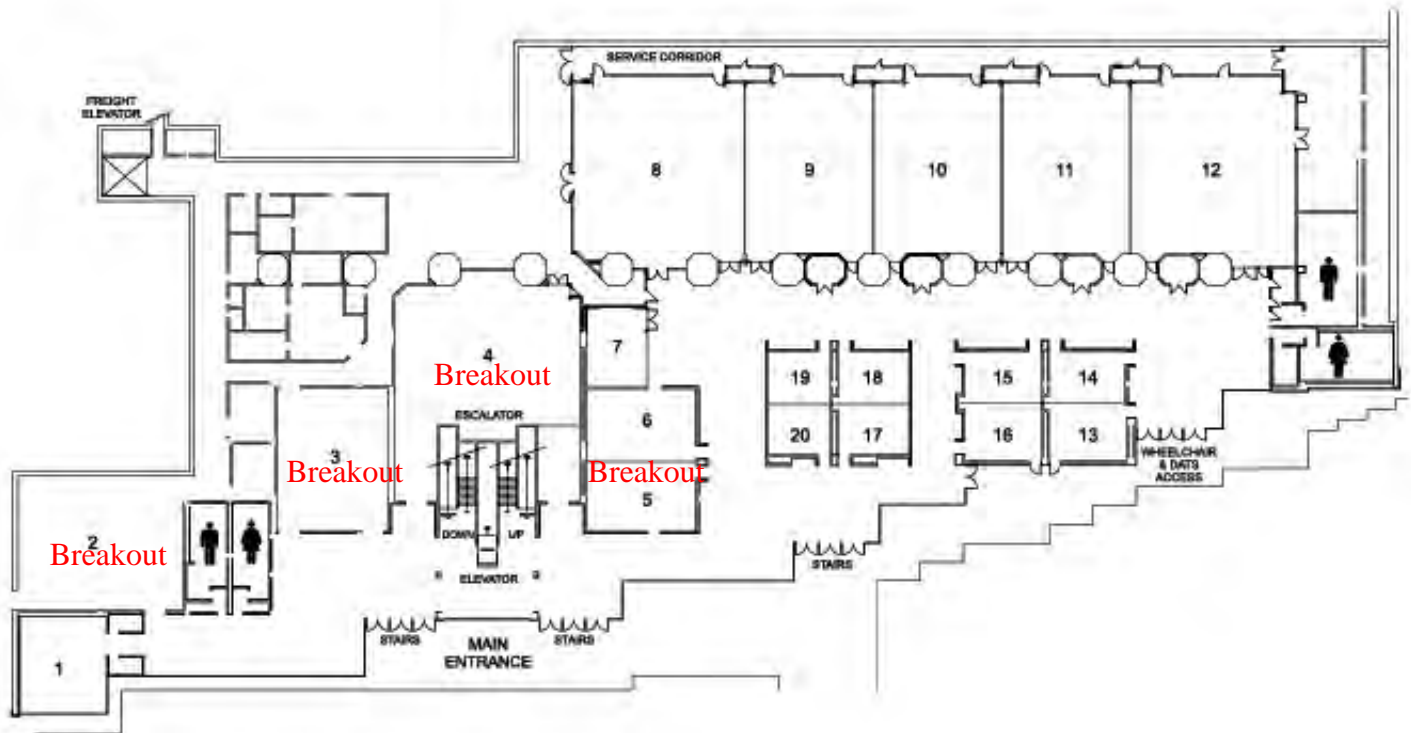

## MEETING LEVEL

## CAPACITY

SALON	HEIGHT (ft)	DIMENSIONS (ft)	AREA (ft <sup>2</sup> )	AREA (m <sup>2</sup> )	THEATRE	BANQUET	CLASSROOM	BOARDROOM	U-SHAPE	SQUARE
1	8' 5"	33 x 30	990	92	50	40	40	18	24	22
2	9' 5"	40 x 57	2,280	212	200	112	100	55	47	58
3	10' 6"	39 x 50	1,950	181	175	96	90	45	45	54
4	10' 5"	49 x 65	3,185	296	300	160	140	50	55	68
5 or 6	9' 8"	38 x 25	950	88	60	48	36	24	25	30
7	9' 8"	28 x 20	560	52	45	24	21	15	17	22
8	11' 6"	62 x 60	3,720	346	320	160	144	50	60	80
9, 10, or 11	11' 6"	62 x 45	2,790	259	250	128	100	40	42	54
12	11' 6"	62 x 58	3,600	334	320	160	144	50	60	80
13, 14, 15, 16	9' 7"	27 x 19	500	48	30	24	18	18	19	23
17 or 18	9' 7"	25 x 18	450	42	25	24	15	15	19	23
19 or 20	9' 7"	22 x 18	395	37	25	24	15	15	19	23
13/14	9' 7"	-	-	-	50	48	36	32	32	37
15/16	9' 7"	-	-	-	50	48	36	32	32	37
17/18	9' 7"	-	-	-	50	48	30	30	28	32
19/20	9' 7"	-	-	-	50	48	30	30	28	32